

RIVER

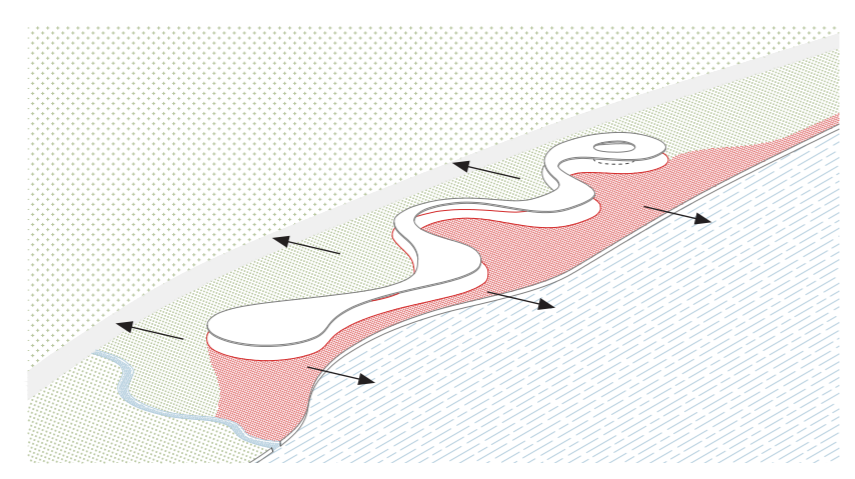

LANDSCAPE & RIVER

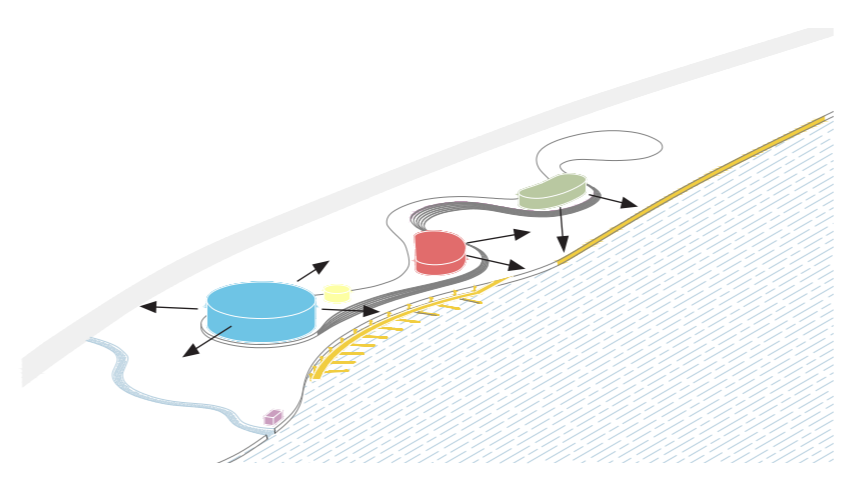

PROGRAM & VIEW

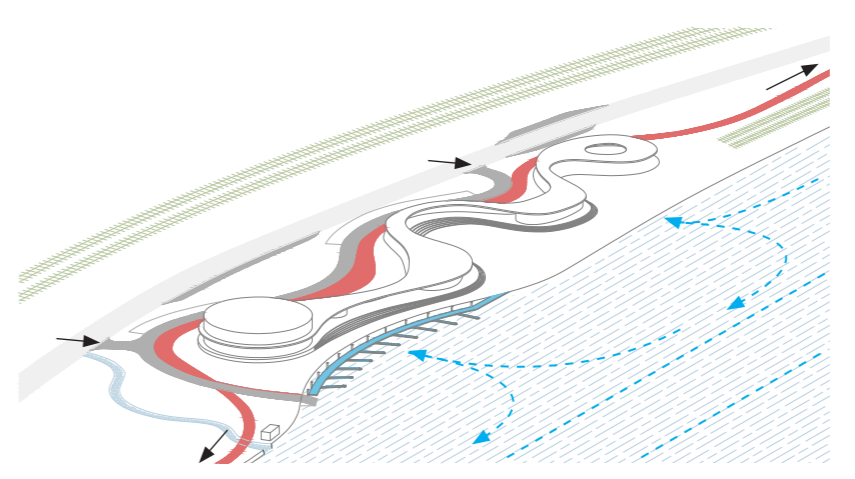

TRAFFIC

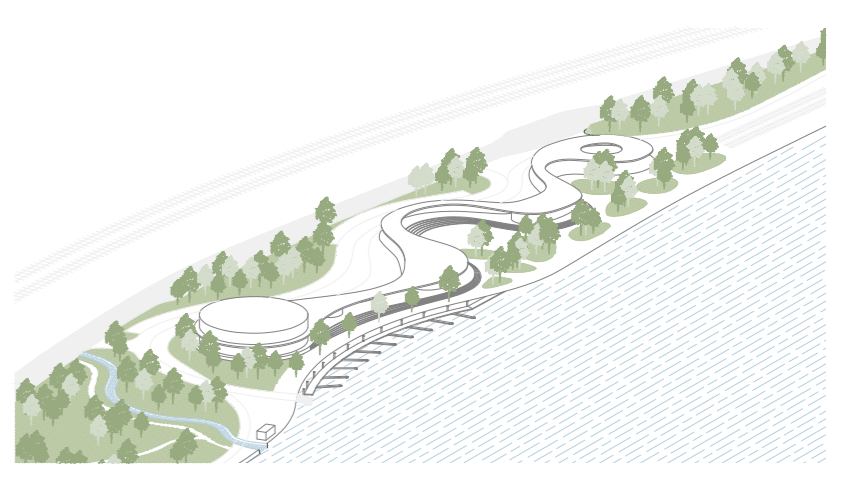

VEGETATION

ÚSTÍ NAD LABEM MARINA

"NATURE CREATES, HUMAN COMPLETES"

The main idea was to design a building that honors and respects the landscape of the Central Bohemian Uplands in valley of the river Elbe and completes the panorama of the landscape in the area of three important monuments, namely Střekov Castle, Masaryk sluice and Vrkoč landscape monument.

The southern area of the city of Ústí nad Labem offers significant potential for the creation of a new dynamic part, which is waiting to be shaped by a landmark of fundamental social and transport importance - which could be the MARINA building. Traffic will be newly connected by a cycle path that will connect at the southern end of the city and lead to the center of Ústí along the riverbed. A railway siding will also be used, which will serve as part of urban transport.

The concept is based on the flow of the river Elbe and its meanders, which flow freely through the protected landscape of the central mountains. The organically formed roof of a wooden structure made of glued trusses and columns hides glazed segments in which the individual functions of the marina were placed (restaurant, waiting room, information center with bar and facilities, accommodation facilities and a cafe).

The aim is for the architecture of the river to become part of the landscape without drawing all the attention to itself and essentially being a single long horizontal plain that seems to float above the surface of the earth.



SECTION



SITE PLAN

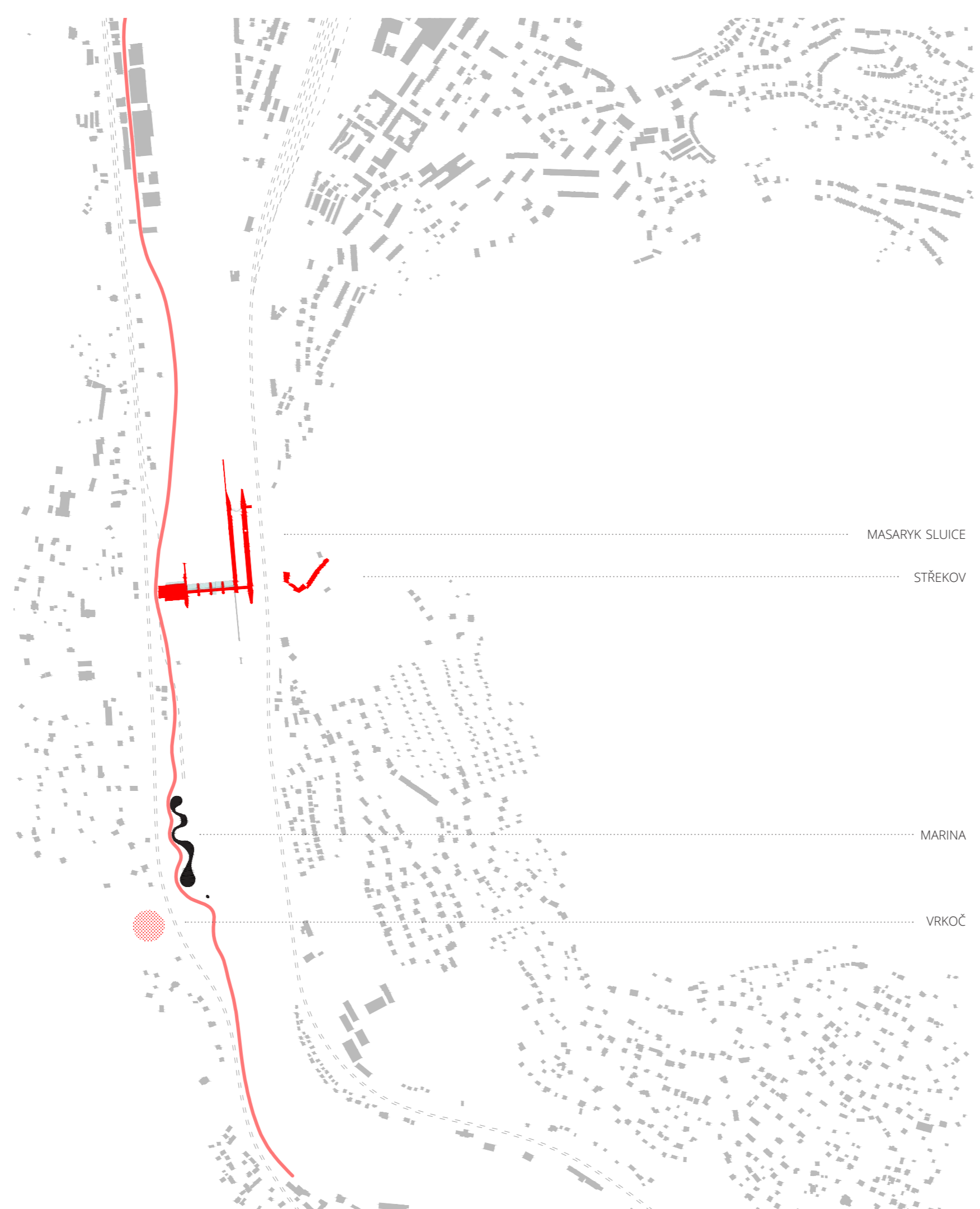

WIDER CONTEXT

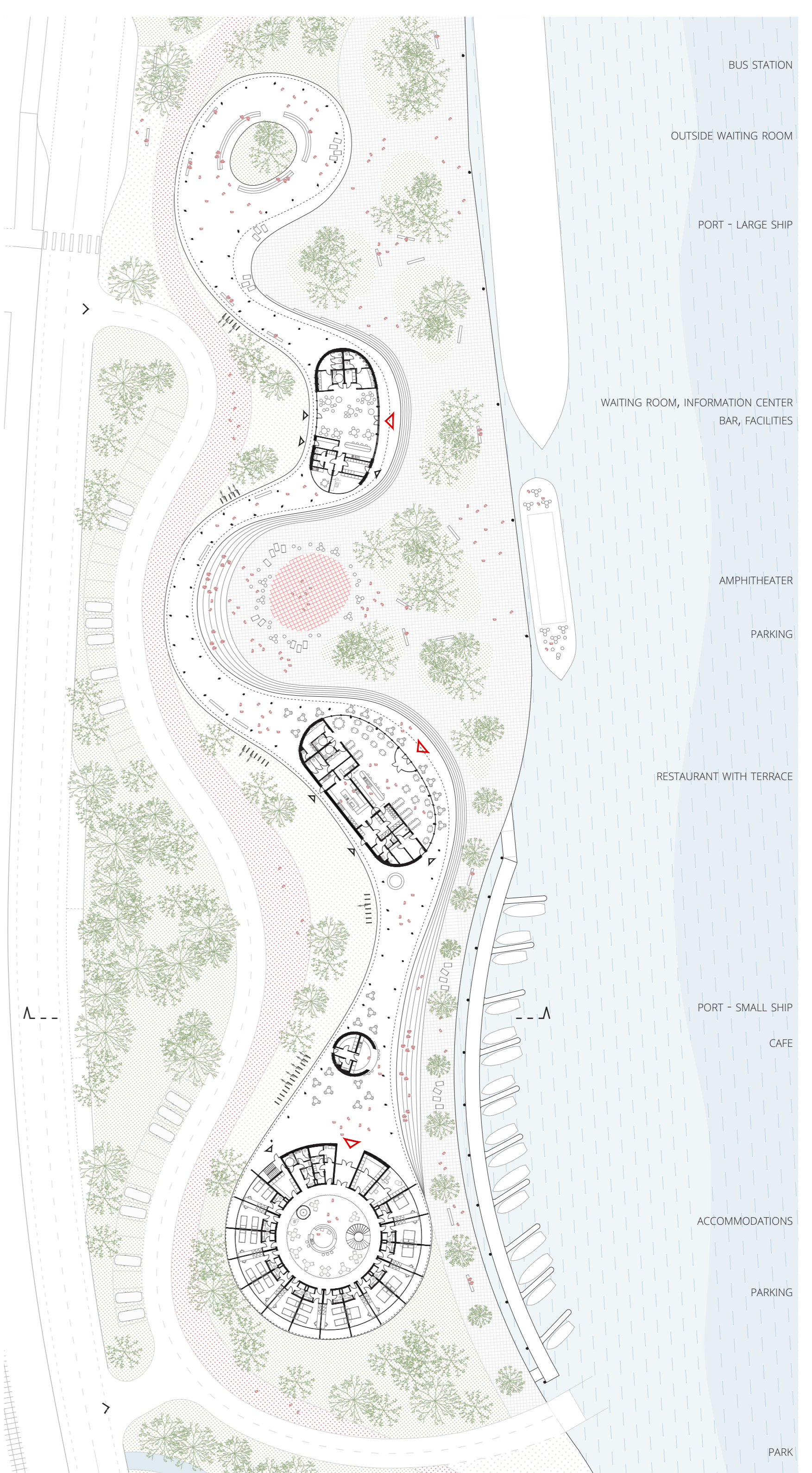

GROUND FLOOR PLAN

- BUS STATION
- OUTSIDE WAITING ROOM
- PORT - LARGE SHIP
- WAITING ROOM, INFORMATION CENTER, BAR, FACILITIES
- AMPHITHEATER
- PARKING
- RESTAURANT WITH TERRACE
- PORT - SMALL SHIP
- CAFE
- ACCOMMODATIONS
- PARKING
- PARK

